

THREADED TOGGLE

Polished Stainless Steel - AISI 316



NO. RIGHT	NO. LEFT	G	PIN	A	B	C	T	L1	L2	L3	B.L./KG	KG/100
023206B	033206B	M6	6	8	17	8	3	88	47	14	1200	5,0
023208B	033208B	M8	8	10	25	9	3	105	57	18	2200	8,3
023210B	033210B	M10	9,5	12	27	12	4	128	63	22	3500	15,4
023212XB	033212XB	M12	12,7	18	33	18	4	154	80	30	5100	30,5
023214B	033214B	M14	12,7	18	33	18	4	172	90	30	6900	33,3
023216XB	033216XB	M16	16	20	41	20	6	199	100	35	9400	63,0
023220XB	033220XB	M20	19	24	43	25	8,0	228	120	40	14700	111,0

Use the threaded toggles to terminate a rigging screw or other attachment where flexible angles are required or there is a risk of failure due to sideways articulation fatigue e.g. with outdoor canopies etc. Available with left handed and right handed threads - also UNF sizes on request.

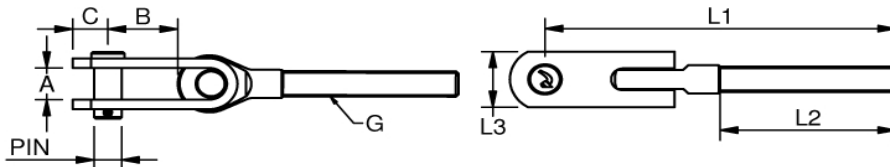

THREADED WALL TOGGLE

Polished Stainless Steel - AISI 316



NO. LEFT	G	D1	L1	L2	L3	L4	B.L./KG	KG/100
03151406	M6	6,4	81	47	40	14	1200	3,8
03151808	M8	8,3	97	57	44	18	2200	6,9

Wall Toggle with left handed thread and pin, for rigging screws, inside thread parts or terminations to flat surfaces.

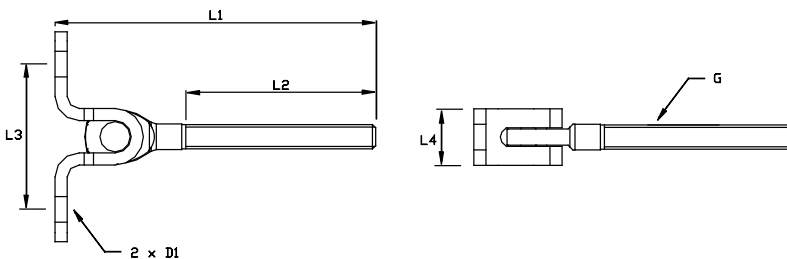

DOMEHEAD SCREW

Stainless Steel - AISI 304



ART. NO.	G	L	D1	KG/100
A50530	M5	30	9,5	0,20
A50535	M6	35	10,5	0,85
A50540	M8	40	14,0	1,90

Threaded domehead screws can be used for end termination and adjustment of a wire e.g. combined with inside thread terminals. The ball for domehead is particularly useful for angled installations.

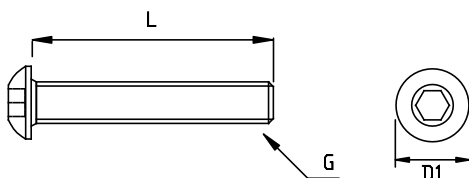

Ball for domehead screw page 50